

Phoenix

Travel in first class



ALCOVE

Maxi | Top | TopX

Pricelist 2022/2023

Standard highlights

STANDARD HIGHLIGHTS OF THE PHOENIX RV'S:

Modern furniture design with well-defined, straight lines and edges

Kitchen worktop in high-quality and elegant mineral granite

Table with solid wood edge and chrome trim

Furniture fronts and doors with chrome handles

Recessed energy-saving LED spotlights

LED reading lights with individual switches

Matt chrome light switches and sockets

Masterly-manufactured furnitures in front frame construction with aluminium profiles

Electric ventilator above the kitchen with thermostat

Hot water central heating ALDE with convectors in living area, bathroom and intermediate floor, with integrated night setback

Engine heat exchanger for heating and cold start

STANDARD HIGHLIGHTS OF THE ALCOVE CLASS:

Strengthened stabilisers on front and rear axle (Daily)

Radio DAB+ in drivers cabine

Comfort shock-cushioning-seats for driver and passenger with seat heating (MAN/Eurocargo: seats with air suspension)

Electrical adjustable and heated rear-view mirrors



Images partly with optional equipment.

The unique assembly concept

STANDARD HIGHLIGHTS OF THE PHOENIX ASSEMBLING

Self-supporting, solid and anti-rotting sandwich-construction with PU-foam-isolation

Electronic controlled entrance-double-step tread with safety circuit

Homogenous and sturdy cabin, GRP-PU sandwich flooring, walls, roof and back made of Aluminium-PU-sandwich

Woodfree, sturdy comb false floor made of fibre-glass reinforced MonoPan

Large flaps for storage space and garage doors with 40 mm wall thickness and twice circular blanket

Lowered frame in reinforced version for vehicles with rear garage

Wide entrance door with window, with two point locking and remote control, false floor flaps, garage doors and entrance door with 1-key-system



10 years density warranty on the assembly against external humidity entry with annual examination according to the Phoenix warranty conditions, except parts from suppliers as flaps, sockets, doors, windows, bonnets etc.

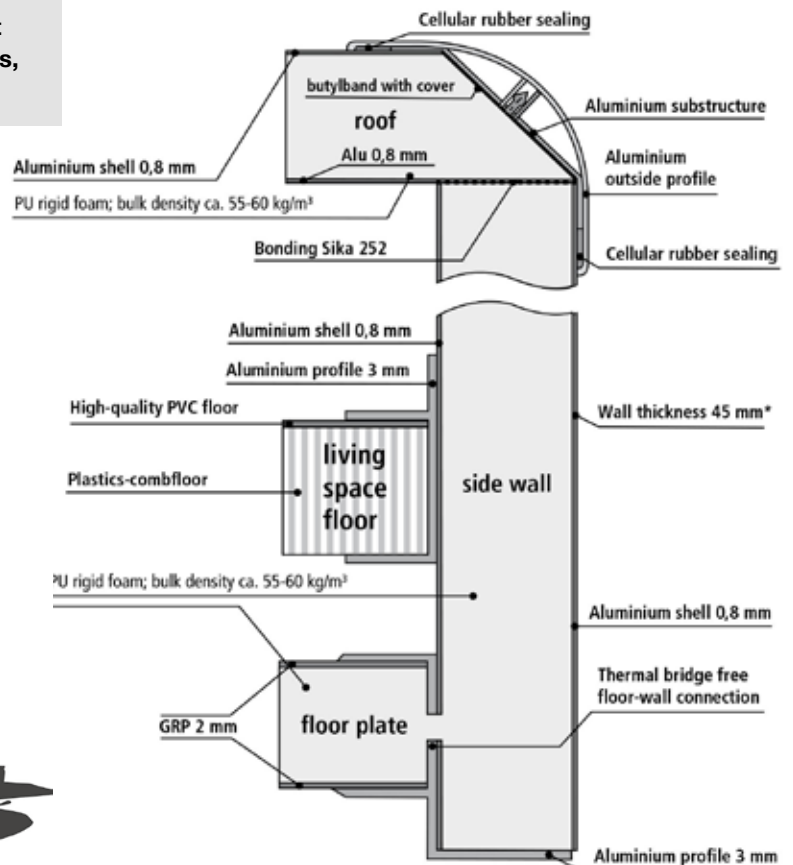

PhoeniX TOP-quality

TOP QUALITY AT THE PHOENIX BODYWORK

Construction from the outside to the inside, first the cabin, then the completion of the interior. This affords a considerably better maintainability and an optimal access to the components in case of repair.

Steadiness of a cube through the assembly of a 42 mm thick Alu-PU-Alu-back wall. Roof and back wall are cemented and rivetted with the side walls. This establishes the greatest possible safety for the passengers and a long-run density of the construction

Homogenous and optimal insulation → complete cabin with 40 mm PU-foam with best values of insulation

Back wall and wheel arches are made of the same insulating material as the side walls and the roof. Excellent insulation – doesn't heat up that much in summer and needs less heating energy in winter.

TOP-QUALITY IN PHOENIX FURNITURES:

The furniture is built in complex front frame architecture with aluminium profiles. → Accurate and close connection

First-class materials, handholds and fittings → The furniture is solid, durable and rattle-free.

Modules of furniture built all of a piece → Harmonious overall picture

TOP-QUALITY IN INSTALLATIONS:

Unique and perfect electrical installation in household quality → Best protection and high reliability, at any time well accessible.

Heating in the false floor with optimal placed motor heat exchanger → Best heat efficiency and high effectiveness.

Assembly of components made by notable producers → That assures a durable and accurate function. The greatest possible convenience with well-engineered application ergonomics is the result of the optimal assembly of first-class components.

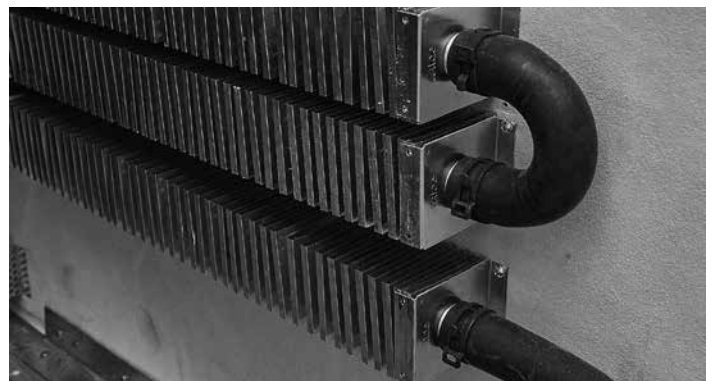
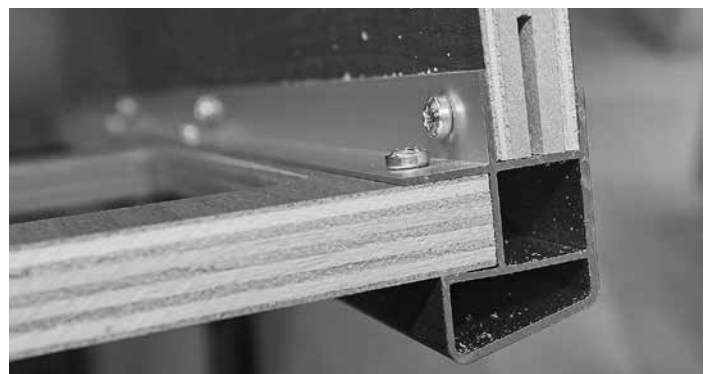

Standard details may vary with special floor plans and special models. Images partly with optional equipment.

PhoeniX individual

INDIVIDUAL

Individualization - we build every PhoeniX for you according to your individual wishes.

We are the exclusive serial producer that also satisfies customer wishes in furniture construction.

Through the exclusive flexible component construction we have the ability to fulfil your individual special requests.

So that our furniture construction in technical TOP-quality meets your special requirements.

We offer you these options:

Design your vehicle with the PhoeniX components

Let us know your customer wishes

Let us help you realising your furnishing requirements

We are pleased to provide you an individual quotation

PHOENIX BATH-VERSION INDIVIDUAL

One size - three versions

For all BM-models: wellness bathroom, one size, three variants selectable

Examples:

Larger rear garage for rear suite models

We build longer beds for tall people

We build larger wardrobes for fashion-conscious people

We build individual rear garages for people who are enthusiastic with motorsports

That way a PhoeniX motorhome gets your individual PhoeniX Alcove

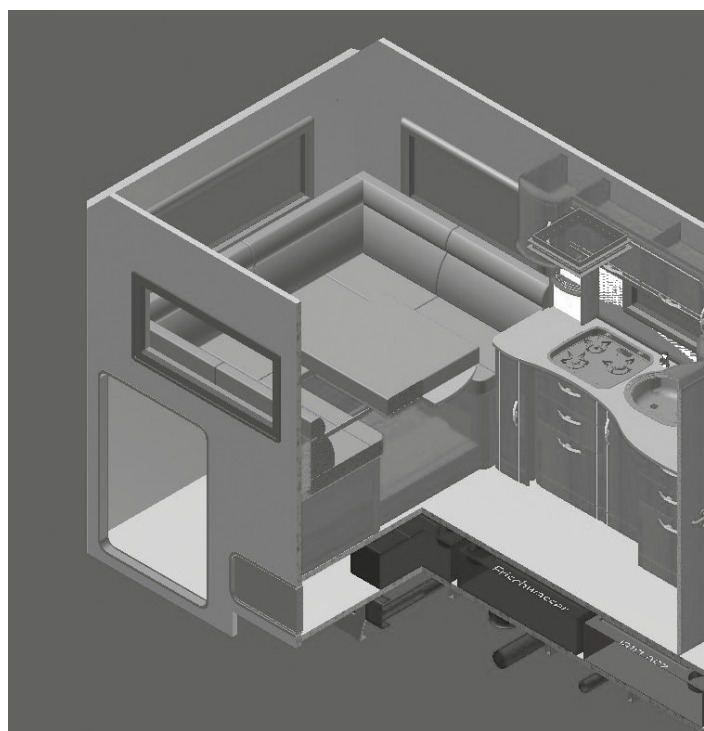

Standard details may vary with special floor plans and special models. Images partly with optional equipment.

2 = Option: Bath with corner washbasin and lockable toilet

1 = Standard bath with open room and big washbasin

3 = Option: Bath with additional wardrobe

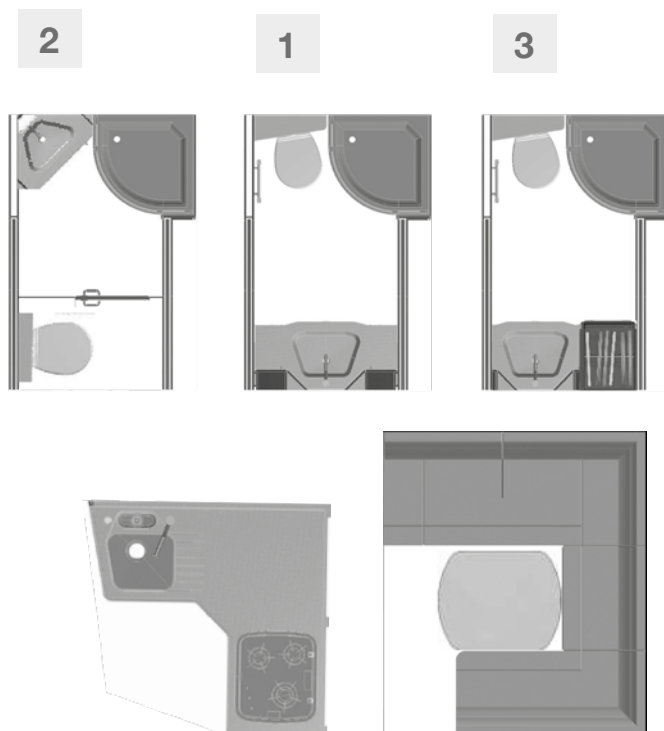

PhoeniX TOP-Alcove on MAN TGL



MAN TGL 8.220 EURO VI E

4,6 l, 4 cylinder common rail engine, 162 kW/220 HP,
2 stage charging
(2 turbo charger), torque of 850 Nm at 1.400 rpm

Alcove 7900 RSL, 7900 QRSL, 8000 BMRSLG, 8300 BMRSLG, 8300 G, 8400 BMQRSL

Wheelbase: 4200 mm, gross vehicle weight: 8.8 t,
optional 7.49 t

Alcove 8800 BGS, 8800 BML

Wheelbase: 4500 mm, gross vehicle weight: 8.8 t,
optional 7.49 t

TOP-ALCOVE MAN TGL 8.220:

6-speed transmission with rear-wheel drive

Batteries in driver's compartment: 140 Ah (instead of 88 Ah)

Tyres: 235/75 R 17,5; front axle: road, rear axle: M+S profile

Fuel tank: 180 l

Air suspension on rear axle

Reinforced shock absorbers

Reinforced front axle

STANDARD EQUIPMENT MAN TGL AND TGM:

28 V / 120 Ah / 3.360 W generator for charging the chassis-/
cabine-batteries while driving

2 sockets, driver's cab in the middle, 12 V and 24 V

Lockable AdBlue tank cap

Trailer load: up to 3,500 kg, depending on total towing
weight and model

Anti-lock braking system (ABS)

MAN EasyControl control panel, 2 functions, can be operated
from the outside with the door open

Control of the parking brake in the instrument panel,
electronic parking brake

Differential lock on rear axle

Compressed air disc brakes on front/rear axle

Compressed air dryer, heated

Pocket ashtray in middle section of instrument panel,
cigar lighter

Electrical adjustable and heated exterior mirrors, additional
kerb mirrors

Electric window lifter on driver's and passenger's side

Electronic immobilizer

ETA automatic circuit breakers instead of fusible cut-out

Grab handle on the inside above all doors of the driver's cab

Harmonization of brake pad wear in the towing vehicle

Air conditioning driver's cab

Fuel prefilter, with oil / water separator, heated with water
sensor (mixing valve)

Steering oil tank with electrical measuring probe

Air compressor, 1 cylinder, 318 ccm, with economy system
(only for TGL with 6-cylinder engine and for TGM)



Standard details may vary with special floor plans and special models.
Images partly with optional equipment.

PhoeniX TopX-Alcove on MAN TGM



STANDARD EQUIPMENT MAN TGL AND TGM:

- Noise-emission certificate for Austria
- Comfort shock-cushioning seats, adjustable in height and bent, with armrests and lumbar support
- Reinforced engine braking
- Serial painting for MAN in color white, silver color painting available as an option
- Seat heating for driver's and co-driver's seat
- Stabilisers on front/rear axle
- Cruise control
- Adjustable steering wheel
- Central locking for driver and passenger door with remote control
- Additional halogen high-beam and fog lights, rectangular
- Electric two-tone horn

MAN TGM 12.290 EURO VI E

6,9 l, 6 cylinder common rail engine, 213 kW/290 HP, 2 stage charging, 1.150 Nm

Alcove 8800 BML

Wheelbase 4425 mm, gross vehicle weight 11990 kg, optional 15 t

Alcove 8900 BMQRSLG, 9300 BM-MB, 9500 AS (Smart garage)

Wheelbase 4725 mm, gross vehicle weight 11990 kg, optional 15 t

Alcove 9900 BML, 9900 BMAS (Smart garage)

Wheelbase 5075 mm, gross vehicle weight 11990 kg, optional 15 t

Alcove 10800 BMAC (Citroen C1 garage), 10800 BMAM (Mini garage)

Wheelbase: 5.425 mm, gross vehicle weight 11990 kg, optional 15 t

TOPX-ALCOVE MAN TGM 12.290:

6-cylinder four-stroke diesel in-line engine with 290 hp

2 Batteries in driver's compartment: 12 V 175 Ah

Tyres: 285/70 R 19.5, front axle: road, rear axle: M+S profile

Fuel tank: 220 l

Air suspension on front and rear axle

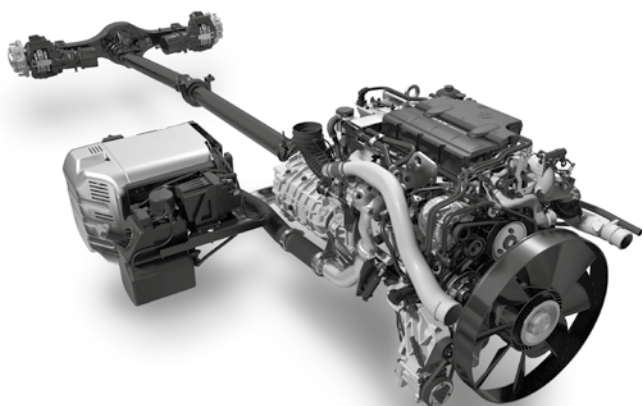

Standard details may vary with special floor plans and special models. Images partly with optional equipment.

IVECO EURO CARGO 75 E 19 EURO VI E

TDI 4,5 l, 4 cylinder engine with 137 kW/190 HP,
max. torque 700 Nm

Alcove 8000 BM RSLG, 8300 G, 8300 BMRSLG, 8400 BMQRSL

Wheelbase: 4185 mm, gross vehicle weight: 7.8 t,
optional 7.49 t

Alcove 8800 BGS, 8800 BML

Wheelbase: 4455 mm, gross vehicle weight: 7.8 t,
optional 7.49 t

TOP-ALCOVE IVECO EURO CARGO 75 E 19

Tyres: 225/75 R 17.5, front axle: road, rear axle: M+S profile

Fuel tank (plastic): 200 l

Front axle load increased to 3600 kg

STANDARD EQUIPMENT 75 E 19 AND 120 E 28:

24 V / 120 Ah / 2.880 W generator for charging the
chassis-/cabine-batteries while driving

Anti-lock braking system (ABS)

Electronic Stability Program (ESP)

Hillholder

Trailer load: up to 3,500 kg, depending on total towing
weight and model

Traction control system (TCS)

Electrical adjustable and heated exterior mirrors, additional
kerb mirrors

Electric window lifter on driver's and passenger's side

Electronic-controlled high pressure-direct injection
(HPCR-Common-Rail)

Electronic immobilizer

EURO 6 standard by HI-eSCR (Selective Catalytic Reduction
with electronic controlled and heated reducer injection
(Adblue)

Tinted driver's cab panes



Standard details may vary with special floor plans and special models.
Images partly with optional equipment.

PhoeniX TopX-Alcove on Iveco EuroCargo 120 E 28 **IVECO**

STANDARD EQUIPMENT 75 E 19 AND 120 E 28:

Chassis stabilisation package
Iveco Control High Line (operating status display with computerized unit)
Iveco comfort seats for driver and passenger, air-suspended, heated and with triple lumbar support
Air conditioning in driver's cab with pollen filter
Ladder frame
Motor with turbocharger and charge-air cooling
Engine brake threefold adjustable
Additional engine compartment insulation
Shift lever integrated in the dash panel in front
Disc brakes on front/rear axle
Power steering
Cruise control
Adjustable steering wheel
Dual-circuit compressed air-braking system
Twin tyres on rear axle

IVECO EURO CARGO 120 E 28 EURO VI E

TDI 6,7 l, 6 cylinder engine with 206 kW/280 HP, max. torque 1000 Nm

Alcove 9300 BM-MB, 9500 AS (Smart garage)
Wheelbase: 4815 mm, gross vehicle weight 11990 kg

Alcove 9900 BML, 9900 BMAS (Smart garage)
Wheelbase: 5175 mm, gross vehicle weight 11990 kg

Alcove 10800 BMAC (Citroen C1 garage)
Wheelbase: 5670 mm, gross vehicle weight 11990 kg

Alcove 11800 BMAM (Mini garage)
Wheelbase: 6570 mm, gross vehicle weight 11990 kg

TOPX-ALCOVE IVECO EURO CARGO 120 E 28:

6 cylinder engine with 280 HP
Tyres: 285/70 R 19.5, front axle: road, rear axle: M+S profile
Fuel tank: 280 l
Air suspension on front and rear axle



Standard details may vary with special floor plans and special models. Images partly with optional equipment.

IVECO DAILY 60 C 18 EURO VI E

TDI 3,0 l, 4 cylinder engine with 129 kW/176 HP, torque 430 Nm

Alcove 7500 G/ST, 7500 RSL

Wheelbase: 4350 mm, 7800 depending on model with wheelbase 4750 mm, gross vehicle weight: 6.0 t

Alcove 7800 G, 7800 RSL, 7800 BMRS, 7900 QRSL

Wheelbase: 4750 mm, gross vehicle weight: 6.0 t

IVECO DAILY 65 C 18 EURO VI E

TDI 3,0 l, 4 cylinder engine with 129 kW/176 HP, torque 430 Nm

Alcove 8000 BMRS, 8300 G

Wheelbase: 4750 mm, gross vehicle weight: 6.5 t

Alcove 8400 BMRS, 8800 BGS, 8800 BML

Wheelbase: 5100 mm, gross vehicle weight: 6.5 t

IVECO DAILY 72 C 18 EURO VI E

TDI 3,0 l, 4 cylinder engine with 129 kW/176 HP, torque 430 Nm

Alcove 9200 AS (Smart garage)

Wheelbase: 5200 mm, gross vehicle weight: 7.2 t



6-speed-transmission with rear drive, optional converter transmission

Trailer load: up to 3,500 kg, depending on total towing weight and model

Anti-lock braking system (ABS)

Traction control system (TCS)

Electrical heated, adjustable exterior mirror with additional wide angle mirror (fixed construction)

Tyres: 225/75 R 16

Common-rail direct injection

Electric window lifter on driver's and passenger's side

Electronic immobilizer

Driver and passenger airbag, seat belt tightener

Rear axle with leaf suspension (semi-elliptical)

Iveco comfort shock-cushioning seats for driver and passenger, adjustable in height, length and bent, with armrests

Air conditioning drivers cabine with increased-output compressor (170 cm³)

Color glass in drivers cabine

Fuel tank 90 l, Fuel filter heating

Ladder frame

Engine with variable turbocharger

Fog lights with static turning lights

Disc brakes on front/rear axle

Stabilisers on front/rear axle

Urea tank 20 l

Cruise control

Reinforced eco-smart-alternator with 2640 W (12 V x 220 A)

Reinforced shock absorbers

Central locking for driver and passenger door with remote control

Twin tyres on rear axle



Standard details may vary with special floor plans and special models. Images partly with optional equipment.

Comfort in every detail as standard equipment

ASSEMBLY

Lowered frame in reinforced construction at vehicles with rear drive

Exterior light 12 V with safety switching (automatic switch off at engine start)

Wide entrance door with window, with two point locking and remote control

Double-floor design, height of double floor: 38.5 cm, heated storage rooms, accessible via outside flaps sideways

Double-glazed and tinted acrylic flipper-/sliding window Seitz D-Lux with comb-combination-blind in the living area

Electronic controlled double-tread with safety switching (automatic draw-in at engine start and closed entrance door), additional control lamp on the dashboard

Rear garage/garage door, size depending on model

Extendable rear bumper bar, resilient up to 150 kg, main carrier-system for bikes and motorbikes (except A models)

Rear wall made of dimensionally stable GRP attached on the Alu-PU-foam-sandwich-panel

Woodfree, sturdy comb-false floor made of fibreglass-reinforced MonoPan panels

Alcove models with passenger car garage with rear rising

Modern motorhome styling

PU-foam isolation, 40 mm, with a high bulk density for best insulation value and absolutely no absorption of humidity

Side skirts made of GRP, optional foldable upwards

Self-supporting, high-tensile and anti-rotting sandwich-design

Lower floor made of anti-rotting GRP-sandwich-panels

Vehicle color Alcove drivers cabine and coachwork in white, sills and rear bumper bar in anthracite, front bumper bar, wheel arches and mirrors in black

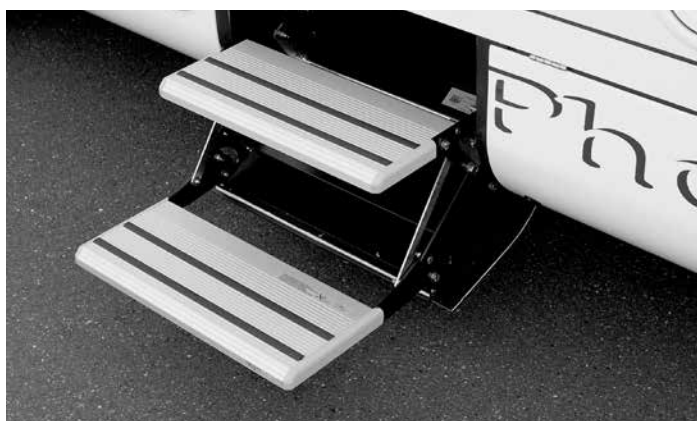

Standard details may vary with special floor plans and special models. Images partly with optional equipment.

Comfort in every detail as standard equipment

INTERIOR

Furniture decor in Erbachahorn

Ceiling canopies with integrated LED room light

RLS-Alcove-model with step tread

LED-light concept with room- and individual light

Kitchen worktop in mineral granite marble with stainless steel basin with cover fixed at the bottom

Bathroom with sophisticated mirror installation

PVC flooring with decor "Royal Oak"

LIVING AREA

Wardrobe in full ceiling-height with inside mirror and lighting

Cushion in fabrics or Microfibre Denver

Spatial separation between sleeping and living area through a sliding door (depends on the floor plan)

Panorama roof-light (HEKI 3) above seating area

High-quality, ergonomically designed luxury cushion

Carpet chained for drivers cab and living area, removable

Walls and ceiling covered with breathable lining material

Living space table with massive wood edge and chrome strip



Standard details may vary with special floor plans and special models. Images partly with optional equipment.

Comfort in every detail as standard equipment

SLEEPING AREA

Homely light through single switching of the LED-reading lamps

Spacious storage shelf for reading material and night utensil

INTERA – the innovative mattress-cover fabric together with Viscoline, the visco-elastic foam material, establish ideal conditions for a recreative sleep

KITCHEN

Double-glazed, tinted flipper window Seitz D-Lux and comb-combination-blind

Rear wall in the kitchen with mineral granite

Large storage lockers with removable bottom

Kitchen worktop made of high-quality mineral granite with calm and elegant decoration

Fridge 100 l incl. 9 l freezer, absorber, irrespective of position, with AES, with LED lightning, 12V / 230 V or gas operation mode

Several drawers with metal separators, cutlery drawer, bin (depends on the model)

Thermostat-controlled roof exhauster (exhaust air/inlet air switchable) above kitchen

Stainless-steel sink with chromed one-handle-household-mixer tap

Spinflo-gas stove, with three burners, combustive automatic, glass cover and splash guard



Standard details may vary with special floor plans and special models. Images partly with optional equipment.

Comfort in every detail as standard equipment

BATHROOM

230 V socket

Shelf for shower utensil with chrome rail and removable towel rack

Arrangeable roof exhauster with combination blind in the shower, at B-models in the bathroom

Bathroom in decor "Erbachahorn" with matching wall decoration

Bath door with massive, rounded metal handle and lock

Lighting with several LED spot lamps

Double-glazed, tinted bathroom window, Seitz D-Lux and comb-combination-blind

Corner rack in bathroom with Mineralgranit

One-handle-houshold-mixer tap on the basin

Integral toilet with flush (Thetford) with removable cassette

Large washbasin floor unit

Separate shower cubicle made of sanitary-acryl with acryl glass door

Mirror cabinet and open racks with chrome rail

Splash water protected lighting in the shower

Toilet paper holder, liquid soap dispenser, towel hook, towel rail, toilet brush and bathrobe hook

Towel radiator with control dial

Washstand in high-strength granite solid surface with seamless moulded-in washbasin, Top-/TopX-class washstand in mineral granit

Mirror on bath door

ADDITIONAL BATHROOM EQUIPMENT IN B-MODELS:

Bathroom washbasin made of granite solid surface with washbasin floor unit and drawers

mirror cabinet

round shower with acryl-glass door



Standard details may vary with special floor plans and special models. Images partly with optional equipment.

Comfort in every detail as standard equipment

ELECTRICITY

1 x 210 Ah gel battery with 30 A charger (Iveco Daily)
2 x 210 Ah gel battery with 60 A charger MAN and Iveco EuroCargo
230 V FI earth leakage circuit breaker
Automatic charging of 12 V/24 V starter battery from 230 V external power source
Automatic charging of auxiliary battery while driving

Digital control panel with percental display of water/waste water-capacities, display of the current power consumption and display of the available energy reserves in percent

Automatic charging with electronic control and temperature monitoring

Living and sleeping room with energy-saving LED-lighting, LED-reading lamps separately switchable

WATER

Waste water drain hose with bayonet connector (storage outside of vehicle)
Automatic and electronic controlled water heating system

Automatic, central pressure water pump

Fresh water and waste water-tank in heated false floor, each with a capacity of ca. 230 l

HEATING AND GAS INSTALLATION

Engine heat exchanger for hot water heating and circulation pump for engine pre-heater
Hot water central heating ALDE with convectors in living area, bathroom and intermediate floor, with integrated night setback
Additional electric heating cartridges 230 V, max. 3000 Watt

Gas bottle compartment for 2 x 11 kg gas bottles

Comfort Duomatic L Plus with remote indication and control knob for determining the operating bottle, with IceEx and crash sensor



Standard details may vary with special floor plans and special models. Images partly with optional equipment.

Technical specifications, measures, weights and prices

IVECO



MaXi-Alkove Iveco Daily

	60 C 18 7500 G/ST	60 C 18 7500 RSL	60 C 18 7800 RSL	60 C 18 7800 G	60 C 18 7800 BMRSL	60 C 18 7900 QRSL****)
Wheelbase	4.350	4.350	4.750	4.750	4.750	4.750
Length	7.950	7.950	8.250	8.250	8.250	8.350
Width	2.350	2.350	2.350	2.350	2.350	2.350
Height ¹⁾	3.450	3.450	3.450	3.450	3.450	3.450
Maximum total weight	6.000	6.000	6.000	6.000	6.000	6.000
Kerb weight *)	4.932	4.750	4.770	4.770	4.770	4.770
Payload **)	1.068	1.250	1.230	1.230	1.230	1.230
Three-point safety belts/lap straps ²⁾	2/2	4	4	2/2	4	4
Number of berths	4-6	3-4	3-4	4-6	3-4	3-4
Seating area ²⁾	2.200 x 1.600	2.200 x 1.760	2.200 x 1.760	2.200 x 1.650	2.200 x 1.760	2.200 x 2.300
Refrigerator ³⁾	97	97	97	97	97	97
Front bed or over cab area bed	2.000 x 1.500	2 x 2.000 x 820	2 x 2.000 x 820	2.000 x 1.500	2 x 2.000 x 820	2 x 2.000 x 820
Rear bed	2.000 x 1.200	-	-	2.000 x 1.500	-	-
Large storage compartment (WxHxL)***)	1.030 x 1.350 x 2.200	930 x 1.180 x 2.200	930 x 1.180 x 2.200	1.500 x 1.350 x 2.200	930 x 1.180 x 2.200	930 x 1.180 x 2.200
Door to large storage compartment on right front-passenger side (WxH)	900 x 1.300	900 x 1.300	900 x 1.300	1.300 x 1.300	900 x 1.300	900 x 1.300
Door to large storage compartment on left driver's side (WxH)	900 x 700	650 x 650	650 x 650	900 x 700	650 x 650	900 x 700
Price model 2023 incl. 19 % tax	212.400,-	212.400,-	218.300,-	218.300,-	222.000,-	222.000,-

„*) Weights and payload according to regulation (EU) Nr. 1230/2012 in standard equipment incl. driver, diesel fuel, fresh water and gas, power cable, without accessories

**) Payload in this catalogue is the difference between total mass and mass in ready to start condition.

***) At measures of garage restrictions foundet from back-lowering, covers, safety frame or something else is possible.

****) Q-models only in combination with stylX-luxury

1) Height measured with HEKI skylight, without optional equipment.

2) Additional persons admission on request.

3) Fridge 118 l or 195 l possible for an additional charge and depends on the model.

The stated prices are for vehicles with standard equipment incl. the stated value added tax. The indications of measurements and weight are approximate, variations in weight and measurements of +/- 5 % are possible.“

Technical specifications, measures, weights and prices

IVECO



MaXi-Alkove Iveco Daily

	65 C 18 8000 BMRSLG	65 C 18 8300 G	65 C 18 8400 BMQRSL****)	65 C 18 8800 BGS	65 C 18 8800 BML	72 C 18 9200 AS
Wheelbase	4.750	4.750	5.100	5.100	5.100	5.200
Length	8.450	8.750	8.850	9.250	9.250	9.650
Width	2.350	2.350	2.350	2.350	2.350	2.350
Height ¹⁾	3.450	3.450	3.450	3.450	3.450	3.580
Maximum total weight	6.500	6.500	6.500	6.500	6.500	7.200
Kerb weight *)	4.890	4.800	4.900	4.940	4.940	5.300
Payload **)	1.610	1.700	1.600	1.560	1.560	1.900
Three-point safety belts/lap straps ²⁾	4	4	4	4	4	2/2
Number of berths	3-4	4-6	3-4	4-6	4-6	4-6
Seating area ²⁾	2.200 x 1.960	2.200 x 2.000	2.200 x 2.300	2.200 x 2.000	2.200 x 2.000	2.200 x 1.550
Refrigerator ³⁾	97	97	97	97	97	97
Front bed or over cab area bed	2 x 2.000 x 820	2.000 x 1.500	2 x 2.000 x 820	2.000 x 1.500	2.000 x 1.500	2.000 x 1.500
Rear bed	-	2.000 x 1.500	-	1.950 X 1.500	2 x 2.000 x 820	2.000 x 1.500
Large storage compartment (WxHxL)***)	1.130 x 1.180 x 2.200	1.500 x 1.350 x 2.200	930 x 1.180 x 2.200	1.500 x 1.350 x 1.750/2.200	1.500 x 1.350 x 2.200	Smart-Garage
Door to large storage compartment on right front-passenger side (WxH)	900 x 1.300	1.300 x 1.300	900 x 1.300	1.300 x 1.300	1.300 x 1.300	900 x 1.300
Door to large storage compartment on left driver's side (WxH)	900 x 700	900 x 700	900 x 700	900 x 700	900 x 700	900 x 1.300
Price model 2023 incl. 19 % tax	224.400,-	224.400,-	232.800,-	239.900,-	239.900,-	277.500,-

„*) Weights and payload according to regulation (EU) Nr. 1230/2012 in standard equipment incl. driver, diesel fuel, fresh water and gas, power cable, without accessories

**) Payload in this catalogue is the difference between total mass and mass in ready to start condition.

***) At measures of garage restrictions foundet from back-lowering, covers, safety frame or something else is possible.

****) Q-models only in combination with stylX-luxury

1) Height measured with HEKI skylight, without optional equipment.

2) Additional persons admission on request.

3) Fridge 118 l or 195 l possible for an additional charge and depends on the model.

The stated prices are for vehicles with standard equipment incl. the stated value added tax. The indications of measurements and weight are approximate, variations in weight and measurements of +/- 5 % are possible.“

Technical specifications, measures, weights and prices

IVECO



Top-Alkove Iveco EuroCargo

	75 E 19 8000 BMRS LG	75 E 19 8300 BMRS LG	75 E 19 8300 G	75 E 19 8400 BMQRS L****)	75 E 19 8800 BGS	75 E 19 8800 BML
Wheelbase	4.185	4.185	4.185	4.185	4.455	4.455
Length	7.900	8.200	8.200	8.300	8.700	8.700
Width	2.450	2.450	2.450	2.450	2.450	2.450
Height ¹⁾	3.450	3.450	3.450	3.450	3.450	3.450
Maximum total weight	7.800	7.800	7.800	7.800	7.800	7.800
Kerb weight *)	6.380	6.420	6.420	6.520	6.620	6.620
Payload **)	1.420	1.380	1.380	1.280	1.180	1.180
Three-point safety belts/lap straps ²⁾	4	4	4	4	4	4
Number of berths	3-4	3-4	4-6	3-4	4-6	4-6
Seating area ²⁾	2.300 x 1.960	2.300 x 1.960	2.300 x 2.000	2.300 x 2.300	2.300 x 2.000	2.300 x 2.000
Refrigerator ³⁾	97	97	97	97	97	97
Front bed or over cab area bed	2 x 2.000 x 820	2 x 2.000 x 820	2.000 x 1.500	2 x 2.000 x 820	2.000 x 1.500	2.000 x 1.500
Rear bed	-	-	2.000 x 1.500	-	2.000 x 1.500	2 x 2.000 x 820
Large storage compartment (WxHxL)***)	1.130 x 1.180 x 2.300	930 x 1.180 x 2.300	1.500 x 1.350 x 2.300	930 x 1.180 x 2.300	1.500 x 1.350 x 1.750/2.300	1.500 x 1.350 x 2.300
Door to large storage compartment on right front-passenger side (WxH)	900 x 1.300	900 x 1.300	1.300 x 1.300	900 x 1.300	1.300 x 1.300	1.300 x 1.300
Door to large storage compartment on left driver's side (WxH)	900 x 700	900 x 700	900 x 700	900 x 700	900 x 700	900 x 700
Price model 2023 incl. 19 % tax	270.100,-	273.800,-	268.900,-	277.400,-	280.000,-	280.000,-

„*) Weights and payload according to regulation (EU) Nr. 1230/2012 in standard equipment incl. driver, diesel fuel, fresh water and gas, power cable, without accessories **) Payload in this catalogue is the difference between total mass and mass in ready to start condition. ***) At measures of garage restrictions founded from back-lowering, covers, safety frame or something else is possible. ****) Q-models only in combination with stylX-luxury

1) Height measured with HEKI skylight, without optional equipment.

2) Additional persons admission on request.

3) Fridge 118 l or 195 l possible for an additional charge and depends on the model.

The stated prices are for vehicles with standard equipment incl. the stated value added tax. The indications of measurements and weight are approximate, variations in weight and measurements of +/- 5 % are possible.“

Technical specifications, measures, weights and prices

IVECO

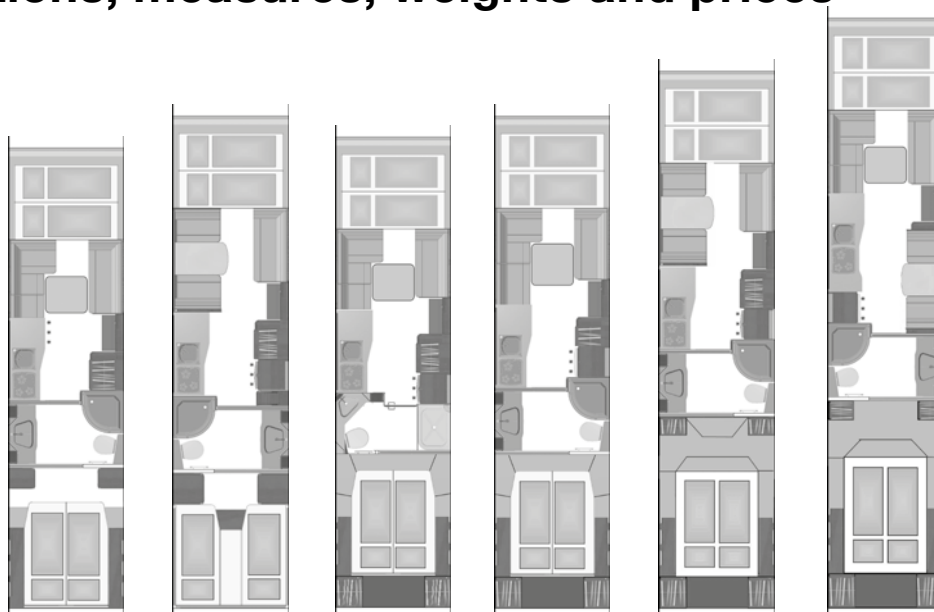

TopX-Alkove Iveco EuroCargo

120 E 28 9300 BM-MB **120 E 28 9900 BML** **120 E 28 9500 AS** **120 E 28 9900 BMAS** **120 E 28 10.800 BMAC** **120 E 28 11.800 BMAM**

Wheelbase	4.815	5.175	4.815	5.175	5.670	6.570
Length	9.200	9.800	9.400	9.800	10.700	11.700
Width	2.450	2.450	2.450	2.450	2.450	2.450
Height ¹⁾	3.650	3.650	3.780	3.780	3.780	3.780
Maximum total weight	11.990	11.990	11.990	11.990	11.990	11.990
Kerb weight *)	7.950	8.190	7.990	8.190	8.510	8.950
Payload **)	4.040	3.800	4.000	3.800	3.480	3.040
Three-point safety belts/lap straps ²⁾	2/2	4	2/2	2/2	4	2/2
Number of berths	4-6	4-6	4-6	4-6	4-6	4-6
Seating area ²⁾	2.300 x 1.500	2.300 x 2.000	2.300 x 1.550	2.300 x 1.850	2.300 x 2.000	2.300 x 1.600
Refrigerator ³⁾	97	97	97	97	97	97
Front bed or over cab area bed	2.000 x 1.500	2.000 x 1.500	2.000 x 1.500	2.000 x 1.500	2.000 x 1.500	2.000 x 1.500
Rear bed	2.000 x 1.600	2 x 2.000 x 820	2.000 x 1.600	2.000 x 1.600	2.000 x 1.600	2.000 x 1.600
Large storage compartment (WxHxL)***)	1.500 x 1.350 x 2.300	1.500 x 1.350 x 2.300	Smart-Garage	Smart-Garage	Citroen C1	Mini-Garage
Door to large storage compartment on right front-passenger side (WxH)	1.300 x 1.300	1.300 x 1.300	900 x 1.300	900 x 1.300	900 x 1.300	900 x 1.300
Door to large storage compartment on left driver's side (WxH)	900 x 700	900 x 700	900 x 1.300	900 x 1.300	900 x 1.300	900 x 1.300
Price model 2023 incl. 19 % tax	329.300,-	336.600,-	351.900,-	361.000,-	382.100,-	415.500,-

„*) Weights and payload according to regulation (EU) Nr. 1230/2012 in standard equipment incl. driver, diesel fuel, fresh water and gas, power cable, without accessories

**) Payload in this catalogue is the difference between total mass and mass in ready to start condition.

***) At measures of garage restrictions foundet from back-lowering, covers, safety frame or something else is possible.

****) Q-models only in combination with stylX-luxury

1) Height measured with HEKI skylight, without optional equipment.

2) Additional persons admission on request.

3) Fridge 118 l or 195 l possible for an additional charge and depends on the model.

The stated prices are for vehicles with standard equipment incl. the stated value added tax. The indications of measurements and weight are approximate, variations in weight and measurements of +/- 5 % are possible.“

Technical specifications, measures, weights and prices

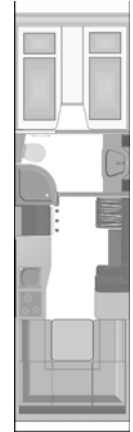
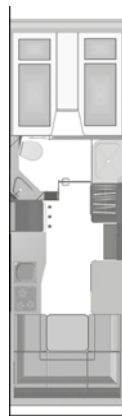

Top-Alkove MAN TGL

	8.220 7900 RSL	8.220 7900 QRSL****)	8.220 8000 BMRSLG	8.220 8300 BMRSLG
Wheelbase	4.200	4.200	4.200	4.200
Length	7.800	7.800	7.900	8.200
Width	2.450	2.450	2.450	2.450
Height ¹⁾	3.450	3.450	3.450	3.450
Maximum total weight	8.800	8.800	8.800	8.800
Kerb weight *)	6.590	6.590	6.630	6.670
Payload **)	2.210	2.210	2.170	2.130
Three-point safety belts/lap straps ²⁾	4	4	4	4
Number of berths	3-4	3-4	3-4	3-4
Seating area ²⁾	2.300 x 1.760	2.300 x 2.300	2.300 x 1.960	2.300 x 1.960
Refrigerator ³⁾	97	97	97	97
Front bed or over cab area bed	2 x 2.000 x 820	2 x 2.000 x 820	2 x 2.000 x 820	2 x 2.000 x 820
Rear bed	-	-	-	-
Large storage compartment (WxHxL)***)	930 x 1.180 x 2.300	930 x 1.180 x 2.300	1.130 x 1.180 x 2.300	1.130 x 1.180 x 2.300
Door to large storage compartment on right front-passenger side (WxH)	900 x 1.300	900 x 1.300	1.000 x 1.300	900 x 1.300
Door to large storage compartment on left driver's side (WxH)	650 x 650	650 x 650	650 x 650	900 x 700
Price model 2023 incl. 19 % tax	305.600,-	305.600,-	311.700,-	315.300,-

„*) Weights and payload according to regulation (EU) Nr. 1230/2012 in standard equipment incl. driver, diesel fuel, fresh water and gas, power cable, without accessories

**) Payload in this catalogue is the difference between total mass and mass in ready to start condition.

***) At measures of garage restrictions foundet from back-lowering, covers, safety frame or something else is possible.

****) Q-models only in combination with stylX-luxury

1) Height measured with HEKI skylight, without optional equipment.

2) Additional persons admission on request.

3) Fridge 118 l or 195 l possible for an additional charge and depends on the model.

The stated prices are for vehicles with standard equipment incl. the stated value added tax. The indications of measurements and weight are approximate, variations in weight and measurements of +/- 5 % are possible.“

Technical specifications, measures, weights and prices

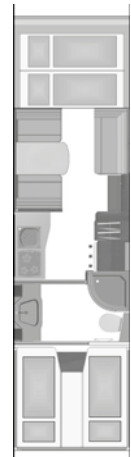

Top-Alkove MAN TGL

	8.220 8300 G	8.220 8400 BMQRSL****)	8.220 8800 BGS	8.220 8800 BML
Wheelbase	4.200	4.200	4.500	4.500
Length	8.200	8.300	8.700	8.700
Width	2.450	2.450	2.450	2.450
Height ¹⁾	3.450	3.450	3.450	3.450
Maximum total weight	8.800	8.800	8.800	8.800
Kerb weight *)	6.670	6.770	6.870	6.870
Payload **)	2.130	2.030	1.930	1.930
Three-point safety belts/lap straps ²⁾	4	4	4	4
Number of berths	4-6	3-4	4-6	4-6
Seating area ²⁾	2.300 x 2.000	2.300 x 2.300	2.300 x 2.000	2.300 x 2.000
Refrigerator ³⁾	97	97	97	97
Front bed or over cab area bed	2.000 x 1.500	2 x 2.000 x 820	2.000 x 1.500	2.000 x 1.500
Rear bed	2.000 x 1.500	–	2.000 X 1.500	2 x 2.000 x 820
Large storage compartment (WxHxL)****)	1.500 x 1.350 x 2.300	930 x 1.180 x 2.300	1.500 x 1.350 x 1.750/2.300	1.500 x 1.350 x 2.300
Door to large storage compartment on right front-passenger side (WxH)	1.300 x 1.300	900 x 1.300	1.300 x 1.300	1.300 x 1.300
Door to large storage compartment on left driver's side (WxH)	900 x 700	900 x 700	900 x 700	900 x 700
Price model 2023 incl. 19 % tax	310.400,-	318.900,-	322.400,-	322.400,-

„*) Weights and payload according to regulation (EU) Nr. 1230/2012 in standard equipment incl. driver, diesel fuel, fresh water and gas, power cable, without accessories

**) Payload in this catalogue is the difference between total mass and mass in ready to start condition.

***) At measures of garage restrictions foundet from back-lowering, covers, safety frame or something else is possible.

****) Q-models only in combination with stylX-luxury

1) Height measured with HEKI skylight, without optional equipment.

2) Additional persons admission on request.

3) Fridge 118 l or 195 l possible for an additional charge and depends on the model.

The stated prices are for vehicles with standard equipment incl. the stated value added tax. The indications of measurements and weight are approximate, variations in weight and measurements of +/- 5 % are possible.“

Technical specifications, measures, weights and prices



TopX-Alkoven MAN TG

	12.290 8800 BML	12.290 8900 BMQRSLG ****)	12.290 9300 BM-MB	12.290 9900 BML
Wheelbase	4.425	4.725	4.725	5.075
Length	8.700	8.800	9.200	9.800
Width	2.500	2.500	2.500	2.500
Height ¹⁾	3.680	3.680	3.680	3.680
Maximum total weight	11.990	11.990	11.990	11.990
Kerb weight *)	8.640	8.680	8.840	9.080
Payload **)	3.350	3.310	3.150	2.910
Three-point safety belts/lap straps ²⁾	4	4	2/2	4
Number of berths	4-6	2-4	4-6	4-6
Seating area ²⁾	2.300 x 2.000	2.300 x 2.300	2.300 x 1.500	2.300 x 2.000
Refrigerator ³⁾	97	97	97	97
Front bed or over cab area bed	2.000 x 1.500	2 x 2.000 x 820	2.000 x 1.500	2.000 x 1.500
Rear bed	2 x 2.000 x 820	–	2.000 x 1.600	2 x 2.000 x 820
Large storage compartment (WxHxL)***)	1.500 x 1.350 x 2.300	1130 x 1180 x 2300	1.500 x 1.350 x 2.300	1.500 x 1.350 x 2.300
Door to large storage compartment on right front-passenger side (WxH)	1.300 x 1.300	1.000 x 1.300	1.300 x 1.300	1.300 x 1.300
Door to large storage compartment on left driver's side (WxH)	900 x 700	900 x 700	900 x 700	900 x 700
Price model 2023 incl. 19 % tax	355.800,-	358.800,-	361.800,-	369.000,-

„*) Weights and payload according to regulation (EU) Nr. 1230/2012 in standard equipment incl. driver, diesel fuel, fresh water and gas, power cable, without accessories

**) Payload in this catalogue is the difference between total mass and mass in ready to start condition.

***) At measures of garage restrictions founded from back-lowering, covers, safety frame or something else is possible.

****) Q-models only in combination with stylX-luxury

1) Height measured with HEKI skylight, without optional equipment.

2) Additional persons admission on request.

3) Fridge 118 l or 195 l possible for an additional charge and depends on the model.

The stated prices are for vehicles with standard equipment incl. the stated value added tax. The indications of measurements and weight are approximate, variations in weight and measurements of +/- 5 % are possible.“

Technical specifications, measures, weights and prices

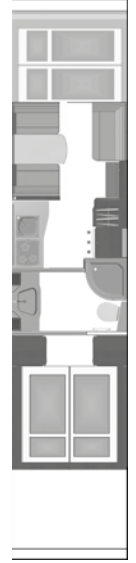
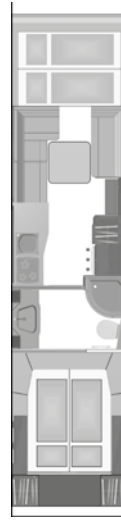

TopX-Alkovn MAN TGM

**12.290
9500 AS**

**12.290
9900 BMAS**

**12.290
10800 BMAC**

**12.2900
10.800 BMAM**

Wheelbase	4.725	5.075	5.425	5.425
Length	9.400	9.800	10.700	10.700
Width	2.500	2.500	2.500	2.500
Height ¹⁾	3.680	3.680	3.680	3.680
Maximum total weight	11.990	11.990	11.990	11.990
Kerb weight *)	8.880	9.080	9.360	9.360
Payload **)	3.110	2.910	2.630	2.630
Three-point safety belts/lap straps ²⁾	2/2	2/2	4	2/2
Number of berths	4-6	4-6	4-6	4-6
Seating area ²⁾	2.300 x 1.500	2.300 x 1.700	2.300 x 2.000	2.300 x 1.900
Refrigerator ³⁾	97	97	97	97
Front bed or over cab area bed	2.000 x 1.500	2.000 x 1.500	2.000 x 1.500	2.000 x 1.500
Rear bed	2.000 x 1.600	2.000 x 1.600	2.000 x 1.600	2.000 x 1.600
Large storage compartment (WxHxL)***)	Smart-Garage	Smart-Garage	Citroen C1	Mini-Garage
Door to large storage compartment on right front-passenger side (WxH)	900 x 1.300	900 x 1.300	900 x 1.300	900 x 1.300
Door to large storage compartment on left driver's side (WxH)	900 x 1.300	900 x 1.300	900 x 1.300	900 x 1.300
Price model 2023 incl. 19 % tax	384.400,-	393.300,-	414.500,-	414.500,-

„*) Weights and payload according to regulation (EU) Nr. 1230/2012 in standard equipment incl. driver, diesel fuel, fresh water and gas, power cable, without accessories

**) Payload in this catalogue is the difference between total mass and mass in ready to start condition.

***) At measures of garage restrictions foundet from back-lowering, covers, safety frame or something else is possible.

****) Q-models only in combination with stylX-luxury

1) Height measured with HEKI skylight, without optional equipment.

2) Additional persons admission on request.

3) Fridge 118 l or 195 l possible for an additional charge and depends on the model.

The stated prices are for vehicles with standard equipment incl. the stated value added tax. The indications of measurements and weight are approximate, variations in weight and measurements of +/- 5 % are possible.“

Accessories in a class of its own

CHASSIS IVECO DAILY		Weight	EUR incl. 19% VAT
26559	Set of aluminium rims Iveco Daily silver with track extension front axle 225/65 R 16 tires and wheel cover rear axle 225/75 R 16 tires		3.510,-
130960	Trailer coupling for Iveco Daily Alcove completely installed for vehicles with rear mask; with ball and 12V/13-pin	50	2.540,-
20107	Trailer connection socket 12V, 13-pin (refitting considerably higher priced)	2	270,-
26056	Chassis load Iveco Daily from 6,000 kg to 6,500 kg gross vehicle weight		1.640,-
26057	Chassis load Iveco Daily from 6,500 kg to 6,700 kg gross vehicle weight		680,-
26203	Chassis load Iveco Daily from 7,200 kg to 7,490 kg gross vehicle weight		2.620,-
26496	Automatic driving light activation, only in combination with driving safety package		870,-
150001	Commitment charge (incl. vehicle registration certificate, full diesel fuel tank, Add blue tank)		770,-
26146	Chassis version 72 C 18 instead of 65 C 18	50	2.770,-
26568	Driving safety package consisting of: electric parking brake, emergency brake assistant (AEBS) + adaptive cruise control (ACC), active lane departure warning, ESP with cross-wind assistant, traction plus with hill descent aid, active tire control system, multi-function steering wheel in leather		10.450,-
26070	Diesel fuel tank 170 l for Iveco Daily	75	2.540,-
20072	Differential lock	10	1.560,-
26581	Spacing washer for 60/70 C rear-axle, each side 45 mm	10	1.150,-
131245	Double-DIN DAB+ radio Hi-Connect without navigation system, with TWIN rear view camera (color); incl. multi-function steering wheel	2	5.500,-
131246	Double-DIN DAB+ radio Hi-Connect with navigation system, with TWIN rear view camera (color); navigation for europe (europe, turkey, russia), incl. multi-function steering wheel	2	5.770,-
26494	Steering wheel adjustable in height and grade		280,-
20063	Air suspension on rear axle	25	6.480,-
26188	Motor with 207 HP instead of 176 HP, only in combination of automatic-gear Hi-Matic		3.430,-
26497	Full-LED passing light and driving light with LED daytime running light		2.680,-
26286	Automatic converter transmission with 8 steps	20	6.850,-
20016	Two manual rear brackets for vehicles with GRP-rear mask	10	680,-



Installation of the above-mentioned accessories will increase the weight of the unloaded production vehicle and decrease the possible payload. Images partly with optional equipment.

Accessories in a class of its own

DELUXE-PACKAGE IVECO DAILY

		Weight	EUR incl. 19% VAT
26471	Deluxe-package Iveco Daily (leather cushion) consisting of:		20.430,-
	Paintwork Alcove drivers cabine and coachwoark in silver, sills and rear bumper bar in anthracite, front bumper bar, wheel arches and mirrors in black		
	Automatic converter transmission with 8 steps (possible for all motors)	20	
	Set of aluminium rims Iveco Daily silver with track extension front axle and wheel cover rear axle		
	Cushion in very high-quality leather		
	Canopy for HEKI 3 with 4 LED spot lamps and dimmer	5	
26520	Deluxe-package Iveco Daily (cushion in stuff) consisting of:		17.150,-
	Paintwork Alcove drivers cabine and coachwoark in silver, sills and rear bumper bar in anthracite, front bumper bar, wheel arches and mirrors in black		
	Automatic converter transmission with 8 steps (possible for all motors)	20	
	Set of aluminium rims Iveco Daily silver with track extension front axle and wheel cover rear axle		
	Cushion in stuff		
	Canopy for HEKI 3 with 4 LED spot lamps and dimmer	5	



Installation of the above-mentioned accessoires will increase the weight of the unloaded production vehicle and decrease the possible payload. Images partly with optional equipment.

Accessories in a class of its own

IVECO

CHASSIS IVECO EURO CARGO		Weight	EUR incl. 19% VAT
29204	Advanced emergency braking system (AEBS) and adaptive cruise control (ACC)		4.440,-
29056	Trailer coupling with ball, voltage converter 24/12 V and 13 pin socket, trailing load according to technical data	25	2.450,-
29091	Automatic manual transmission EUROTRONIC	15	4.670,-
150171	Commitment charge (incl. vehicle registration certificate, full diesel fuel tank, Add blue tank)		990,-
29010	Differential lock	15	1.100,-
29016	Compressed-air connection in garage	3	210,-
29203	Lane Departure Warning System (LDWS)		1.150,-
26521	Radio DAB+, TWIN rear view camera (color) and navigation system for rv's (31 EU-countries), bluetooth hands-free speakerphone, navi considers length, width, height, campgrounds and parking position integrated	2	4.970,-
29028	Front bumper face bar and drivers cabine mud guard in color of drivers cabin, head lamp cleaning station incl.fog lamp	2	2.630,-
29014	Front shield heated	1	670,-
29013	Heated air drier	3	210,-
26523	Multi-function steering wheel	2	430,-
29217	Xenon headlights inclusive headlamp cleaner		1.200,-
29017	Central locking for driver and passenger door with infrared remote control	4	680,-

CHASSIS IVECO EURO CARGO 75 - 100 E

29025	Wheel trims 17,5" in stainless steel with chrome-rim look	12	1.010,-
29187	E21 4 cylinder-engine with 154 kW (210 HP), max. torque 750 Nm at 1.250 rpm instead of E 19	30	2.350,-
29489	Chassis reduction from 7.8 t to 7.49 t permissible gross weight (only possible with suitable weight balance)		1.740,-
29190	Chassis 80 E 21 with 8 t gross vehicle weight instead of 75 E 21	270	4.370,-
29189	Chassis 80 E 22, 6 cylinder-engine with 162 kW (220 HP), max. torque 800 Nm at 1.250 rpm instead of 75 E 19	460	9.620,-
29007	Air suspension on rear and front axle (not for 75 E models, serie for 120 E models)	58	8.420,-
29006	Air suspension on rear axle	27	5.680,-

CHASSIS IVECO EURO CARGO 120 E

29350	Wheel trims 19,5" in stainless steel with chrome-rim look	12	1.230,-
-------	---	----	---------



Installation of the above-mentioned accessoires will increase the weight of the unloaded production vehicle and decrease the possible payload. Images partly with optional equipment.

Accessories in a class of its own

DELUXE-PACKAGE EURO CARGO		Weight	EUR incl. 19% VAT
29346	Deluxe-package Eurocargo 75 - 100 leather cushion: Paintwork Alcove drivers cabine and coachwoark in silver, sills and rear bumper bar in anthracite, front bumper bar, wheel arches and mirrors in black Automatic manual transmission EUROTRONIC Wheel trims 17,5" in stainless steel with chrome-rim look Cushion in very high-quality leather Canopy for HEKI 3 with 4 LED spot lamps and dimmer	32	17.580,-
29347	Deluxe-package EuroCargo 75 - 100 E cushion stuff: Paintwork Alcove drivers cabine and coachwoark in silver, sills and rear bumper bar in anthracite, front bumper bar, wheel arches and mirrors in black Automatic manual transmission EUROTRONIC Wheel trims 17,5" in stainless steel with chrome-rim look Cushion in stuff Canopy for HEKI 3 with 4 LED spot lamps and dimmer	32	14.240,-
29348	Deluxe-package Eurocargo 120 E leather cushion: Paintwork Alcove drivers cabine and coachwoark in silver, sills and rear bumper bar in anthracite, front bumper bar, wheel arches and mirrors in black Automatic manual transmission EUROTRONIC Wheel trims 19,5" in stainless steel with chrome-rim look Cushion in very high-quality leather Canopy for HEKI 3 with 4 LED spot lamps and dimmer	32	17.710,-
29349	Deluxe-package EuroCargo 120 E cushion stuff: Paintwork Alcove drivers cabine and coachwoark in silver, sills and rear bumper bar in anthracite, front bumper bar, wheel arches and mirrors in black Automatic manual transmission EUROTRONIC Wheel trims 19,5" in stainless steel with chrome-rim look Cushion in stuff Canopy for HEKI 3 with 4 LED spot lamps and dimmer	32	14.400,-



Installation of the above-mentioned accessoires will increase the weight of the unloaded production vehicle and decrease the possible payload. Images partly with optional equipment.

Accessories in a class of its own



MAN TGL/TGM		Weight	EUR incl. 19% VAT
500681	Foldable storage table on codriver side	2	910,-
500738	Change of Speed from 89 km/h to 119 km/h		270,-
500057	MAN trailer coupling with ball, trailing load according to technical data (available up to model 10 600)	25	3.740,-
500058	Trailer connection socket 12V, 13-pin with 24/12 V voltage converter (refitting considerably higher priced) (available up to model 10 600)	5	2.110,-
500051	Automatic 12-speed manual transmission with automatic clutch for 6-cylinder motor (TGL/TGM)	15	5.440,-
500683	Attention alert MAN Attention Guard plus tachograph, only in combination with driving safety package		860,-
500036	Battery master switch, manual starter battery		310,-
150061	Commitment charge (incl. vehicle registration certificate, full diesel fuel tank, Add-Blue-tank)		990,-
500038	Aluminium compressed-air reservoir	-5	1.100,-
500737	Driving safety and driving comfort package: Lane departure warning LDW, speed control ACC distance controlled, emergency brake assist EBA, cannot be switched off, emergency brake signal with warning flash activation automatic, instrument cluster professional 12.3 „“, driving light switch, automatic, with lightsensor, high beam assistant, automatik windscreen wiper actuation with rain sensor (automatik wiper)		11.750,-
500698	Front pane laminated safety glass (VSG), tinted and heatable		1.010,-
500701	Headlights LED, fog lights LED + turning light LED (only Alcove)		4.980,-
500689	Interior styling chrom		970,-
500116	Air conditioned driver seat		940,-
500735	Paintwork mirror cover, front bumper and entrances in white		2.910,-
500736	Paintwork mirror cover, front bumper and entrances in silver		3.630,-
500596	Multi-function steering wheel in leather		2.220,-
500599	Entry handles, leather (only for alcove)		1.100,-
500674	PhoeniX/MAN media-system navigation professional 12,3", DAB+, with navigation, incl. TWIN rear view camera (color)		6.840,-
500675	MAN Soundsystem Advanced		1.220,-
500673	PhoeniX/MAN media-system advanced 7", DAB+, without navigation, incl. TWIN rear view camera (color)		5.500,-
500042	Wheel trims in stainless steel with chrome-rim look	12	1.000,-
500095	Sun blind at both doors	2	460,-
500099	Footrest for passenger		270,-
500102	Compressed air external connection with 20 m hose and pressure gauge: Assembly in the garage!		360,-
500725	Additional water heating, 6 kw (only Alcove)	10	4.290,-
500083	Aluminium rims MAN 6,75 - 17,5 (1 package = 7 pieces)	-56	3.290,-

Installation of the above-mentioned accessories will increase the weight of the unloaded production vehicle and decrease the possible payload. Images partly with optional equipment.

Accessories in a class of its own



MAN TGL		Weight	EUR incl. 19% VAT
500486	Aluminium rims MAN Alcoa Dura Bright 6,75 - 17,5 (1 package = 7 pieces)	-56	5.230,-
500569	MAN EfficientRoll transmission function (not for 4-cylinder engine)		380,-
500050	Automatic 6-speed manual transmission with automatic clutch for 220 HP, 4-cylinder motor (only TGL)	10	4.300,-
500189	Additional diesel fuel tank 180 l on drivers side incl. brackets, holders and connecting line (only for wheelbase 4.850 mm and larger)		2.870,-
500208	Digital axle load display (ALM) in the cab for air-sprung axles		1.150,-
500443	Air horn (amplified horn; actuated via horn button)		1.360,-
500813	Chassis reduction from 8.8 t to 7.49 t permissible gross weight (only possible with suitable weight balance)		1.740,-
500055	Chassis load from 8.8 t to 10 t gross vehicle weight (10.220)	140	7.020,-
500056	Chassis load from 10 t to 12 t gross vehicle weight (12.220)	210	7.110,-
500053	Chassis configuration MAN TGL 8.250: 6,9 l, 6-cylinder common-rail motor, 184 kW/250 HP, torque of 1000 Nm at 1,200 - 1,750 rpm, 9-speed manual transmission (standard at 11.200 BMA and 11.600 BMA)	385	7.550,-
500678	Chassis configuration 12.290 instead of 8.220		38.930,-

MAN TGM		Weight	EUR incl. 19% VAT
500679	Chassis configuration 15.290 instead of 12.290		17.530,-
500626	Aluminium rims MAN Alcoa Dura Bright 19,5 x 8,25 (1 package = 7 pieces)	-56	8.800,-
500623	Diesel fuel tank 300 l instead of 220 l for MAN TGM	90	470,-
500756	Engine output 235 kW / 320 hp instead of 213 kW / 290 hp for MAN TGM with 15 t zGG (only in conjunction with chassis version 15.290)		4.930,-

Posibilities to save weight at MAN TGL:

115 l position or 115 l as main tank instead of 230 l fresh water	-115
Aluminium rims instead of steel rims	-56
LI-Power-Package (MAN) with 1 x 210 AH Lithium-Iron-Phosphate-battery instead of 2 x 210 AH gel battery	-97
LI-Power-Package (MAN) with 2 x 210 AH Lithium-Iron-Phosphate-battery instead of 2 x 210 AH gel battery	-74
3 person registration instead of 4 person registration	-85
2 person registration instead of 4 person registration	-170
Enclose the spare wheel loosely instead of permanently attached	-50



Installation of the above-mentioned accessories will increase the weight of the unloaded production vehicle and decrease the possible payload. Images partly with optional equipment.

Accessories in a class of its own



DELUXE-PACKAGE MAN		Weight	EUR incl. 19% VAT
130577	Deluxe-package MAN leather cushion: Paintwork Alcove drivers cabine and coachwork in silver, sills and rear bumper bar in anthracite, front bumper bar, wheel arches and mirrors in black Automatic 6-speed manual transmission with automatic clutch for 220 HP, 4-cylinder motor Aluminium rims MAN 6,75 - 17,5 (1 package = 7 pieces) Cushion in very high-quality leather Canopy for HEKI 3 with 4 LED spot lamps and dimmer	-56	19.020,-
500653	Deluxe-package MAN cushion stuff instead of cushion leather	-56	15.680,-
500676	Deluxe-package MAN cushion leather Paintwork Alcove drivers cabine and coachwork in silver, sills and rear bumper bar in anthracite, front bumper bar, wheel arches and mirrors in black Automatic 12-speed manual transmission with automatic clutch for 6-cylinder motor Aluminium rims MAN Alcoa Dura Bright 19,5 x 8,25 (1 package = 7 pieces) Cushion in very high-quality leather Canopy for HEKI 3 with 4 LED spot lamps and dimmer	-56	23.950,-
500677	Deluxe-package MAN cushion stuff instead of cushion leather	-56	20.650,-



Installation of the above-mentioned accessories will increase the weight of the unloaded production vehicle and decrease the possible payload. Images partly with optional equipment.

Accessories in a class of its own

ASSEMBLY		Weight	EUR incl. 19% VAT
120878	Alcove bed foldable upwards for comfortable passage to the driver's cab (only with MAN and Iveco EuroCargo, not possible with lengthwise beds)	5	940,-
130625	Alcove raising, approx. 13 cm including roof rack	10	2.970,-
131184	Alcove raising long, only for vehicles with round-seat, approx. 13 cm including roof rack	15	5.110,-
131082	Alcove raising long, only for vehicles with dinette, approx. 13 cm including roof rack	15	4.330,-
120992	Outside awning, 5.0 m, with integrated 230 V-motor and LED-Strip; colour grey	49	2.860,-
120850	Outside awning, 5.5 m, with integrated 230 V-motor and LED-Strip; colour grey	54	2.890,-
120813	Outside awning, 6.0 m, with integrated 230 V-motor and LED-Strip; colour grey	59	3.040,-
131181	D-Lux- window with glass (not all sizes)	20	6.190,-
150179	Two additional safety lap belts towards direction of traffic (for dinette)	20	750,-
130244	Garage door 130 x 130 cm (W x H) on driver's side instead of 90 x 70 cm (W x H)	10	500,-
130209	Garage door 90 x 130 cm (W x H) on driver's side instead of 90 x 70 cm (W x H)	8	430,-
130591	Set of lift brackets with 4 brackets for Iveco Daily, with automatic levelling	150	10.730,-
130698	Set of lift brackets with 4 brackets for MAN / Iveco Eurocargo, with automatic levelling	150	11.140,-
150164	Additional Mini-HEKI without forced venting	6	240,-
131187	Panorama roof-light HEKI 3 instead of skylight for alcove- or rear bed	12	1.840,-
130329	Seitz-Midi-HEKI roof-light instead of skylight for alcove or rear bed	10	750,-
150143	Additional flare flap	2	540,-
120974	Standing height 2.13 m continuously along the entire length, only MAN TGL and Iveco Eurocargo (serie MAN-TGM)	50	6.480,-
130715	Strap-securing system for large storage compartment, completely installed with straps	2	500,-
131156	Strap-securing system Airline for large storage compartment, with 5 tie rods and lashing material	10	1.560,-



Installation of the above-mentioned accessoires will increase the weight of the unloaded production vehicle and decrease the possible payload. Images partly with optional equipment.

Accessories in a class of its own

PAINTWORK

		Weight	EUR incl. 19% VAT
130516	Vehicle color Alcove drivers cabine and coachwoark in silver, sills and rear bumper bar in anthracite, front bumper bar, wheel arches and mirrors in black		12.640,-
130517	Paintwork sills and rear bumper bar in silver		2.740,-
131295	Paintwork sills and rear bumper bar in silver		2.510,-



Installation of the above-mentioned accessoires will increase the weight of the unloaded production vehicle and decrease the possible payload. Images partly with optional equipment.

Accessories in a class of its own

GAS - WATER		Weight	EUR incl. 19% VAT
130154	Additional cesspit (115 l)	12	750,-
150211	Flush connection via filler for cesspit (as at fresh water)	1	270,-
131141	Alde Flow	12	900,-
130026	Outside shower	2	390,-
130898	City outside water connection with pressure reducer (without Gardena-quick connector and hose)	2	460,-
120156	Separate ventilation for cesspit via roof	1	260,-
130171	Additional fresh-water tank (115 l)* incl. plug (no plug in RSL-models)	132	750,-
130129	Additional fresh-water tank (230 l)* incl. plug (no plug in RSL-models)	258	800,-
130025	Outside gas socket	1	260,-
130024	Gas baking oven luxury style (instead of crockery shelf) with grill, highisolating glassdoor	23	1.320,-
130488	Gas tank 90 l completely installed with E20 67R01 0404 permission additionally to standard installation for gas bottle	96	3.150,-
150137	Heating circuit in rear bed area, switchable with three-way valve and bypass	1	530,-
130103	Ceramic toilet with fixed tank (115 l)*	30	2.390,-
130185	Ceramic toilet with fixed tank (230 l)	40	2.680,-
131140	Ceramic toilet with bidet and fixed tank (230 l)	40	2.770,-
130060	Additional toilet ventilation (SOG) via roof (not for fixed-tank toilet)	1	490,-
130027	Second slide-in toilet cassette, with holder	5	280,-



* Number and size of additional fresh water, waste water and lavatory tanks depends on the particular specification of the vehicle. Installation of the above-mentioned accessories will increase the weight of the unloaded production vehicle and decrease the possible payload. Images partly with optional equipment.

Accessories in a class of its own

ELECTRICITY - POWER SUPPLY

		Weight	EUR incl. 19% VAT
131217	Electric-Power-Package (Iveco Daily) with additional 210 AH gel battery (= 2 x 210 AH), with converter 12V/230V Sinus AC voltage, continuous output 3000 VA / 2400 W and remote control, plus 10 additional plug sockets (7 x 230 V, 3 x double USB)	90	5.110,-
131218	Electric-Power-Package (Eurocargo/MAN) with additional 210 AH gel battery (= 3 x 210 AH), with converter 12V/230V Sinus AC voltage, continuous output 3000 VA / 2400 W and remote control, plus 10 additional plug sockets (7 x 230 V, 3 x double USB)	90	5.110,-
131284	LI-Power-Package (Iveco Daily) with 1 x 210 AH Lithium-Iron-Phosphate-battery instead of 1 x 210 AH gel battery, with converter 12 V/230 V Sinus AC voltage, continuous output 3000 VA / 2400 W and remote control, plus 10 additional plug sockets (7 x 230 V, 3 x double USB)	-27	9.350,-
131285	LI-Power-Package (Iveco Daily) with 2 x 210 AH Lithium-Iron-Phosphate-battery instead of 1 x 210 AH gel battery, with converter 12 V/230 V Sinus AC voltage, continuous output 3000 VA / 2400 W and remote control, plus 10 additional plug sockets (7 x 230 V, 3 x double USB)	-4	13.820,-
131286	LI-Power-Package (MAN/Iveco Eurocargo) with 1 x 210 AH Lithium-Iron-Phosphate-battery instead of 2 x 210 AH gel battery, with converter 12 V/230 V Sinus AC voltage, continuous output 3000 VA / 2400 W and remote control, plus 10 additional plug sockets (7 x 230 V, 3 x double USB)	-97	8.760,-
131287	LI-Power-Package (MAN/Iveco Eurocargo) with 2 x 210 AH Lithium-Iron-Phosphate-battery instead of 2 x 210 AH gel battery, with converter 12 V/230 V Sinus AC voltage, continuous output 3000 VA / 2400 W and remote control, plus 10 additional plug sockets (7 x 230 V, 3 x double USB)	-74	13.230,-
131288	LI-Power-Package (MAN/Iveco Eurocargo) with 3 x 210 AH Lithium-Iron-Phosphate-battery instead of 2 x 210 AH gel battery, with converter 12 V/230 V Sinus AC voltage, continuous output 3000 VA / 2400 W and remote control, plus 10 additional plug sockets (7 x 230 V, 3 x double USB)	-51	17.700,-
131073	Converter with safety switching at generator installation		910,-
130247	Generator 2.6 KW, TEC 29, 4-stroke petrol-driven, with internal switch, 15-litre fuel tank, option converter only in combination with Art. 131073	78	6.850,-
130808	Solar plant 165 W incl. solar charge controller	20	2.140,-
130809	Solar plant 2 x 165 W incl. solar charge controller	38	3.620,-



* Recommended accessories 1) recommendation solar plant 2) Please observe the battery capacity when using an inverter; sensitive loads may result in troubles. Installation of the above-mentioned accessories will increase the weight of the unloaded production vehicle and decrease the possible payload. Images partly with optional equipment.

Accessories in a class of its own

ELECTRICITY - INSTALLATION DEVICE		Weight	EUR incl. 19% VAT
131077	Alarm system completely with infrared-sensors in drivers cabine and reed contacts on doors and flaps of the false-floor	6	1.930,-
130278	Compressor fridge 195 l incl. sep. 44 l freezer instead of 100 l, 12 V-mode, energy-efficiency class A plus (power consumption approx. 320 W/24 hrs. at ambient temperature of 32°C), mounting option is model-specific	10	1.120,-
130277	Compressor fridge 118 l incl. sep. 17 l freezer instead of 100 l, 12 V-mode, energy-efficiency class A-plus; (power consumption approx. 280 W/24 hrs. at ambient temperature of 32°C)	6	550,-
130814	Roof air conditioning Aventa Comfort, cooling capacity 2.400 watt	34	2.890,-
130583	Dishwasher in kitchenette for 4 place settings, front decor in silver	20	1.610,-
120939	Induction cooker 2 flame (only in combination with electro- oder LI-power-package) instead of gas stove 3 flames	20	3.110,-
130737	Microwave without grill, 230 V-mode, installed in the wall cupboard above the kitchenette	8	1.590,-
130018	Additional roof-ventilator, with thermostat (standard in kitchen)	5	650,-
131249	Central vacuum-cleaning system with high throughput (950 W), 12 m flexible hose	3	1.410,-

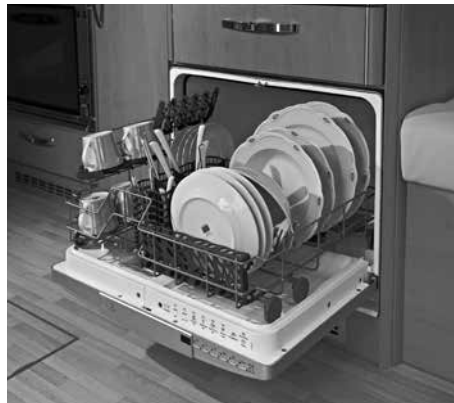

* Recommended accessories 1) recommendation solar plant 2) Please observe the battery capacity when using an inverter; sensitive loads may result in troubles. Installation of the above-mentioned accessories will increase the weight of the unloaded production vehicle and decrease the possible payload. Images partly with optional equipment.

Accessories interiordesign

ELECTRICITY - RADIO / NAVIGATION / SOUND / TV

		Weight	EUR incl. 19% VAT
130088	Radio for living area	1	680,-
130833	Sound system consisting of radio for living area, amplifier, 4 integrated loudspeakers	2	1.650,-
131237	Full-automatic TWIN-TV/satellite unit Oyster V 85 with 24" TFT-tv (receiver integrated) in wall unit, electric lowerable, tv-preparation in sleeping room (12 V, antenna)	38	8.140,-
131238	Full-automatic TWIN-TV/satellite unit Oyster V 85 with 32" TFT-tv (receiver integrated) in tall wall unit, electric lowerable, tv-preparation in sleeping room (12 V, antenna)	38	8.270,-
131239	Full-automatic TWIN-TV/satellite unit Oyster V 85 with 24" TFT-tv (receiver integrated) in entrance area or at sideboard, tv-preparation in sleeping room (12 V, antenna)	38	7.480,-
131248	Full-automatic TWIN-TV/satellite unit Oyster V 85 with 32" TFT-tv (receiver integrated) in entrance area or at sideboard, tv-preparation in sleeping room (12 V, antenna)	38	7.600,-
131240	Full-automatic TWIN-TV/satellite unit Oyster V 85 with 24" TFT-tv (receiver integrated) in sideboard, manual extendable, tv-preparation in sleeping room (12 V, antenna)	38	7.750,-
131241	Full-automatic TWIN-TV/satellite unit Oyster V 85 with 32" TFT-tv (receiver integrated) in QRSL sideboard, electric extendable, tv-preparation in sleeping room (12 V, antenna)	38	8.270,-
131242	Cytrac DX instead of Oyster V85, this article only in combination with full-automatic TWIN-TV/satellite unit		
130963	TFT flat-screen TV (24") with integrated receiver, DVD-Player and CI-Slot (depending on model)	9	1.320,-
131118	TFT flat-screen TV (32") with integrated receiver, DVD-Player and CI-Slot	10	1.440,-



* Recommended accessories 1) recommendation solar plant 2) Please observe the battery capacity when using an inverter; sensitive loads may result in troubles. Installation of the above-mentioned accessories will increase the weight of the unloaded production vehicle and decrease the possible payload. Images partly with optional equipment.

Accessories interiordesign

STONE OAK AND NEW TIBERINO NUT



Installation of the above-mentioned accessories will increase the weight of the unloaded production vehicle and decrease the possible payload. Images partly with optional equipment.

Accessories interiordesign

INTERIOR DESIGN STYLX-LUXURY

		Weight	EUR incl. 19% VAT
131226	StylX luxury marble (=bright) for standard models (= models with square shower)	50	7.580,-
131227	StylX luxury amber (=brown) for standard models (= models with square shower)	50	7.580,-
131228	StylX luxury cliff (=grey) for standard models (= models with square shower)	50	7.580,-
131229	StylX luxury marble (=bright) for B-models (= models with quadrant shower)	35	7.320,-
131230	StylX luxury amber (=brown) for B-models (= models with quadrant shower)	35	7.320,-
131231	StylX luxury cliff (=grey) elegance for B-models (= models with quadrant shower)	35	7.320,-
131232	StylX luxury marble (=bright) for TOP-/TopX-models (EuroCargo + MAN)	25	7.060,-
131233	StylX luxury amber (=brown) for TOP-/TopX-models (EuroCargo + MAN)	25	7.060,-
131234	StylX luxury cliff (= grey) for TOP-/TopX-models (EuroCargo + MAN)	25	7.060,-



Installation of the above-mentioned accessories will increase the weight of the unloaded production vehicle and decrease the possible payload. Images partly with optional equipment.

Accessories interiordesign

INTERIOR DESIGN STYLX-LUXURY

Weight

EUR incl.
19% VAT

Choice of the fronts in combination with stylX-luxury:

131221 Fronts in Bergahorn highgloss

131222 Fronts in highgloss white

Mineral granite for kitchen worktop, sink (stainless steel ground) with cover, kitchen rear wall

- marble
- amber
- cliff

Ceiling canopy in leather with integrated LED-light

- colour bright

Carpet chained, removable

- colour grey-brown

Microfiber wallcovering

High-class and massive water-tap in bathroom and kitchen

Make up mirror in bathroom with LED individual light

Nightlight with LED-point-light

OPTIONS IN COMBINATION WITH STYLX-LUXURY

131180 Cabinet body decor "stone-oak" in combination with wall unit covers high gloss white or Bergahorn, only with stylX-luxury

2.070,-

131281 Cabinet body decor "tiberino-nut" in combination with wall unit covers high gloss white or Bergahorn, only with stylX-luxury

2.070,-



Installation of the above-mentioned accessoires will increase the weight of the unloaded production vehicle and decrease the possible payload. Images partly with optional equipment.

Accessories interiordesign

FURNITURE

			Weight	EUR incl. 19% VAT
999	Realisation of customer preferences in furniture construction	Price on request		
120941	Rackboard in alcove on drivers- and co-drivers side above window frame		2	430,-
130869	Apothecary cabinet, room-high with 3 adjustable clip baskets		20	2.030,-
131190	Canopy for Heki 3 with 4 LED spot lamps and dimmer		4	670,-
130875	Canopy for Midi Heki with 4 LED spot lamps and dimmer		4	600,-
130876	Canopy for Mini Heki with 2 LED spot lamps		2	500,-
131154	Glass-fronted cabinet in the kitchen (for lowerable coffee-board)		5	390,-
120860	BM-bath with lockable toilet room		10	1.320,-
120849	BM-bath with wardrobe usable in full ceiling height with doors, clothes rail and lower shelf (width 400 mm)		10	1.320,-
130836	Half-light package: front and rear area and indirect illumination of lamps in corners		3	1.370,-
120993	Corner rack with open storage place			730,-



Installation of the above-mentioned accessoires will increase the weight of the unloaded production vehicle and decrease the possible payload. Images partly with optional equipment.

Accessories interiordesign

FURNITURE

		Weight	EUR incl. 19% VAT
130832	Electrically lowerable coffee shelf inkl. Socket (230 V) and coffee maker, only with cabinet of glasses	2	680,-
131064	Glass-fronted cabinet with TFT section instead of wardrobe, with 2 matching shelves and 8 glasses	6	1.160,-
121056	Wardrobe 400 cm wide and refrigerator tall cabinet and small sideboard instead of wardrobe 600 with fridge under the sideboard.	15	1.300,-
131157	Rear wall in kitchen with acrylglass, only in combination with stylX-luxury	3	500,-
130644	LED light strip in glass cabinet (small), illumination in blue		100,-
131247	Table lowerable with table cushion for modification to a bed	10	560,-
120598	Sliding doors in opposite direction between bathroom and rear bed	20	1.440,-
120994	Special sideboard with 3 large drawers	30	1.840,-
130855	Drawer under the bench/in the socle of the RS-table	5	320,-



Installation of the above-mentioned accessoires will increase the weight of the unloaded production vehicle and decrease the possible payload. Images partly with optional equipment.

Accessories in a class of its own

CUSHION / CURTAIN / ROLLER BLIND		Weight	EUR incl. 19% VAT
130807	BICOLOR with leather/drapery-combination: upper and lower ridge in drapery, back and seat in leather		3.010,-
130806	BICOLOR with leather/drapery-combination: upper and lower ridge in leather, back and seat in drapery		2.450,-
130618	BICOLOR with leather cushion		210,-
131155	Wood-jalousie (price for each window)		390,-
260192	Cushion in very high-quality leather		4.470,-
165597	Roman blinds		570,-
165598	Roman blinds with continuous line		1.150,-



Installation of the above-mentioned accessories will increase the weight of the unloaded production vehicle and decrease the possible payload. Images partly with optional equipment.

The fine print

Accessories and original parts for PhoeniX-motorhomes offered by Schell Fahrzeugbau GmbH have been specifically developed and tested. Any change of the factory-provided status not approved by Schell Fahrzeugbau GmbH may lead to a spoiling of warranty, density warranty, driving and transport safety.

The indications of measurements and weight are approximate, variations in weight and measurements of +/-5% are possible. The stated weights and payload are calculated according to regulation (EU) Nr. 1230/2012 in standard equipment incl. driver, diesel fuel, fresh water, gas, power cable, without accessories and without passenger car. The water supply installation at least corresponds to state of the art 03/2009 (Directive 2002/72/EG)

The stated payload of PhoeniX-motor homes will decrease with the installation of accessories and optional equipment. The installation of extra equipment, additional water tanks and their charging may change the axle load. The loading of the vehicle and the compliance with the gross axle weight rating respectively the permissible maximum weight has to be checked and to be considered before driving. Special floor plans and special editions may vary from the weight specifications and technical data.

All prices for vehicles, optional equipment and accessories are valid until the next edition of this price list and are quoted in € included VAT. All prices are recommended retail prices ex works. The prices for optional equipment and accessories are only valid with factory-provided installation and duly disposal.

Reorders in a period of 12 weeks before the agreed delivery date require an agreement of the delivery possibilities.

Reorders within 12 weeks before the agreed delivery date may cause additional charges.

Technical changes, misprints and errors expected!

Driving licence C/CE for motor homes above 7,5 t

Nationwide there are many driving schools, where you can get a driving licence straightforward and quickly in weekly courses. Often they also offer holiday courses. The success rate of the passed tests is 94%.

Driving licence class C

With this licence you are allowed to drive motor homes (and lorries) above 7,5 t gross vehicle weight and a trailer up to 750 kg gross weight.

The training for the class C licence normally lasts one week at many driving schools. The course includes a theoretical and a practical part, each with a test. The theory rotates with the driving. The charges are ca. 1.800 € plus separate fees for public authorities.

Driving licence class CE

With this licence you are allowed to drive motor homes (and lorries) above 7,5 t gross vehicle weight and a trailer above 750 kg gross weight (up to 40 t gross vehicle mass). The training for the class CE licence normally also lasts one week, but there are made higher demands than in class C. The charges are ca. 2.400 € plus separate fees for public authorities.

You need the following documents:

- 1 passport photograph
- Ophthalmologic attestation
- Medical certificate
- First aid course (2 x 8 hours for lorries)

With these documents you apply for one of the above-named driving licences at your appropriate Driving Licence Agency. As soon as you have the documents back, you may pass the test.

Many driving schools will gladly arrange a nearby motor home-site or a hotel room.

The translation was carried out as well as possible, but if there is still a difference between the translated version and the original German version, only the German version is legally valid. No liability is accepted for linguistic errors in this context. The customer is asked to also consult the German version.



Schell Fahrzeugbau GmbH · Phoenix-Reisemobile
Sandweg 1 · 96132 Aschbach
Tel. 095 55.92 29 - 0 · Fax 095 55.92 29 - 29
info@phoenix-reisemobile.de · www.phoenix-reisemobile.de